

## What you will need:



Metal Tape



Pencil



Screwdriver (Phillips Head)  
or Phillips Bit



Electric Drill

## What's supplied with your 50mm Aluminium Venetian Blind:



On Face Bracket

or



Reveal Bracket



Drill Bit



Fixings



Wall Cleat

## Things to note:

- The drill bit and fixings have been supplied based on what was called up at time of order.
- The brackets supplied will be either for a Recess or On Face installation, again this is dependent upon what you chose at time of ordering.
- The number of brackets supplied for each blind will vary depending on the width. Smaller blinds will require 2 brackets, larger blinds 3 or 4.

## Bracket Fixing Options



Top Fix  
(Recess Fit)

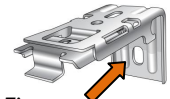

Side Fix  
(Face Fit)

We recommend fitting 1 fixing screw per bracket.

## Where to install your brackets:

When installing the brackets, please ensure you do not install them over the ladder cord mechanisms or tilt control

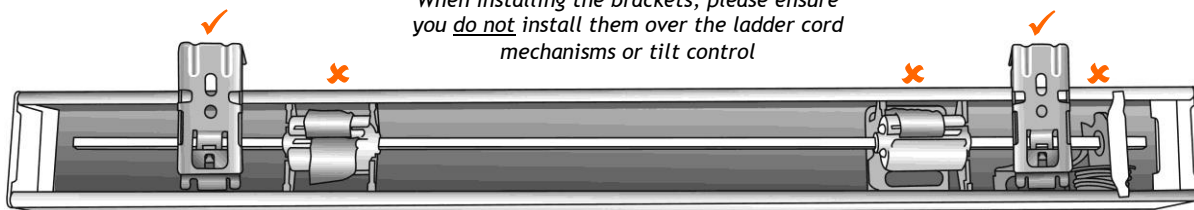

- For both Recess and On Face applications install the brackets no further than 100mm in from either side. Additional brackets, (if supplied), are to be installed across the remaining width. It is preferable to install the brackets so they don't interfere with the ladder and control mechanisms.

## Installing inside the window frame (Recess Fit):

- When installing into the window frame ensure that the brackets are positioned so the blind will not hit any window handles or other protrusions when being operated.

- Brackets should be installed so they are evenly distributed across the width of the blind.
- Using a pencil and the brackets provided position the bracket where you want it to go and mark the inside of the holes with a pencil. Remove the bracket and pre-drill the holes using the drill bit provided. Repeat for the other brackets.
- Fix the brackets securely with the fixings provided. Use 1 fixing screw per bracket.

### Installing outside the window frame (Face Fit)

- Brackets should be installed so they are evenly distributed across the width of the blind.
- Using a pencil and the brackets provided, position the bracket where you want it to go and mark the inside of the holes with a pencil. Remove the bracket and pre-drill the holes using the drill bit provided. Repeat for the other brackets.
- Fix the brackets securely with the fixings provided. Use 1 fixing screw per bracket.

### Installing your Venetian Blind into the brackets:

- Position the blind by first placing the top front edge of the headbox, (A), into the front lugs of the bracket. Once contact has been made rotate the headbox back, then push up to orient it into place, (B). Secure the blind by pushing firmly until you hear a definite, 'click,' (C). Repeat for the other brackets.

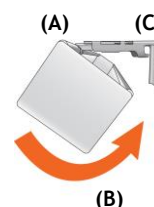

### Fitting the Cord Cleat:

- It is a requirement under Australian Law that the Cord Cleat must be attached to the wall or window frame, 1600mm above floor level to avoid the potential of a choking hazard. Please read the additional information provided when installing the enclosed Cord Cleat.

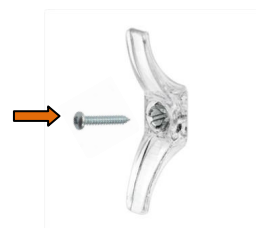

### Fitting Hold Down Clips:

- Hold Down Clips can be fitted to the bottom of your blind. Place the clips at the bottom of the window so they line up with the bottom rail edge of the blind. Screw the clips into place with two screws if fixing into wood or aluminium, or screws and wall plugs if installing into plaster. Take care not to over tighten the screws.



### Operating your 50mm Aluminium Venetian Blind:

- Rotate the slats open or closed by pulling on one of the two shorter cords.
- To raise the blind first tilt the slats so they are in the fully open position. Then pull the long cord using a continuous, smooth movement. At the desired height lock the blind by angling the cord appropriately away from the blind.
- To lower the blind unlock the cord lock by angling the cord towards the centre of the blind. Allow the blind to drop slowly until you reach the desired position.

### Care and Maintenance of your 50mm Aluminium Venetian Blind:

Regularly dust using a clean soft cloth, a feather duster or a vacuum. Slats may be wiped over with a slightly damp cloth to remove more stubborn dirt.

### If you need to take down your Venetian Blind:

- Fully raise the blind and lock off the cord lock.
- Disengage the bracket lever by applying firm pressure to the top of the bracket. A flat head screwdriver or kitchen knife can assist when unlocking the bracket. Repeat for all brackets.

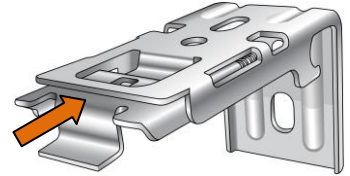

**Still unsure? Call us on  
1300 006 669  
or email  
[sales@buyblindsonline.com.au](mailto:sales@buyblindsonline.com.au)**

## IMPORTANT: PLEASE READ BEFORE INSTALLATION

**WARNING: Young Children Can Strangle in the Loop of Pull Cords, Chains and Bead cords and Cords that run through Window Coverings. They can also wrap cords around their necks. To avoid strangulation and entanglement, keep cords out of reach of children. Also install safety devices that remove the cord loop or reduces access to cords and move cots and furniture away from window covering cords.**



- To avoid creating a possible strangulation hazard for children, the corded internal window covering must be installed so that a loose cord cannot form a loop of 220mm or longer at a height of less than 1600mm above the floor level.
- A cord retainer may be installed lower than 1600mm above the floor level if the cord is sufficiently secured or tensioned to prevent a loop 220mm or longer from being formed.
- The cord retainer reduces the hazard of strangulation or entanglement by limiting access to the cord or bead chain. It must be fixed to the wall immediately below the blind by means of a screw with the cord or cords sitting within the device so a child cannot pull the cord or bead chain around their neck
- If a cord retainer is installed lower than 1600mm above the floor level it must be designed to prevent a child from being able to remove the cord.
  - Fixing to brick - use rawl or wall plug, (5mm drill), and 25mm 6 gauge screw.
  - Fixing to aluminium - use 6 gauge self-drilling screw
  - Fixing to timber - use 20mm 8 gauge self-drilling screw.



Recommendations above are minimum sizes. Longer and heavier gauge screws may be used.

- If a cleat is used to secure the cord it must be at least 1600mm above floor level because a child is capable of unwinding a cord from a cleat.

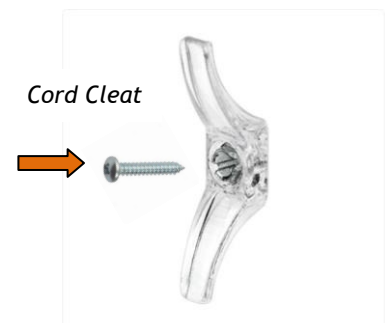

**WARNING: CURTAIN AND BLIND CORDS HAVE CAUSED THE DEATH OF YOUNG CHILDREN AND MUST BE INSTALLED SO THAT THEY ARE NOT A STRANGULATION HAZARD. FOLLOW THE INSTALLATION INSTRUCTIONS.**